

WARREN AREA ELEMENTARY CENTER



343 EAST FIFTH AVENUE • WARREN PA 16365
PHONE (814) 723 - 9061 • FAX (814) 726-1785

MRS. RUTH NELSON • PRINCIPAL

MS. ANN RYAN • ASSISTANT PRINCIPAL

July 28, 2010

Dear Dr. Kennerknecht:

The Warren Elementary PTO Board requests approval to proceed with the installation of an additional playground at WAEC designed and created by General Recreation, Inc., the same company who designed the current playground. We ask that the board approve a Lease/Release Agreement for the playground to be constructed at the southwest corner site where the two drives leading to WAEC meet.

The playground design and price quote are included with this letter. The components comprising the playground will be different from those on the current playground. Areas of it will be handicap accessible, and the addition of the sensory play panel will offer stimulating activities especially appropriate for our autistic and mentally retarded children.

The PTO has agreed to assume the cost of the quote from General Recreation, Inc. and asks that the district support this effort by providing equipment and manpower to drill the holes and spread the ground cover. For safety reasons, we also request that the district provide the fencing to surround the playground. We will be seeking community support and grant money to offset the cost from our general PTO budget.

Planning for this project has been completed by the PTO Executive Board and the principals. Installation of this structure will be done with parent and community support and coordinated by Curt Bischof from General Recreation hopefully in early October 2010.

We are excited to begin this project for our students and children and hope that you will be able to support this effort. Enclosed are diagrams of the general layout, the plans, and the cost of the structure. We appreciate your consideration in this matter.

Sincerely,

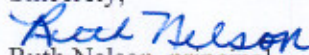
Ruth Nelson, principal

Committee Members:

Ruth Nelson, principal
Ann Ryan, principal
Jen Wortman, PTO Co-President
Maria Stanton, PTO Co-President
George Peck, PTO treasurer

Leah Thomas, parent
Alice Fadale, parent
JoAnn Gazdak, parent
Megan Yeager, teacher
Mary Beyer, teacher

Rachael Oser, teacher
Ann Buerkle, principal SSEL

Nelson, Ruth

From: curtis [curtis1512@comcast.net]
Sent: Tuesday, July 27, 2010 12:43 PM
To: Nelson, Ruth
Subject: Playground holes?

Ruth,

If we go with all the equipment on the second quote, the number of holes is 42. That would include the structure and sensory panels.

Thanks,

Curtis Bischof

www.generalrecreationinc.com
curtis@gen-rec.com
412-341-6224
866-341-6224
FAX:412-341-6711



Please consider the environment before printing this message.

↑

PRICE QUOTE
DATE: 7/2/2010

QUOTE # 070210A

By: CURTIS BISCHOF

PH: 412-341-6224

TF: 866-341-6224

FX: 412-341-6711

CUST: WARREN AREA SCHOOL DISTRICT
ELEMENTARY CENTER

ATTN: RUTH NELSON

GENERAL RECREATION, INC.

1512 GREENTREE ROAD

PITTSBURGH, PA 15220

General Recreation, Inc.

1-800-726-4793
TERMS: NET 30

SHIPPED BY: CC

F. O. B.: DEL

SHIP DATE: 3-4 WEEKS

PHONE: 814-723-2451

FAX:

Quantity	Model #	DESCRIPTION	Each	Total
LANDSCAPE STRUCTURES, INC.				
1	44615-1-2	CUSTOM DESIGNED PLAYBOOSTER PLAY STRUCTURE	\$32,050.00	\$32,050.00
1	168662A	SENSORY PLAY PANEL MARBLE	\$2,780.00	\$2,780.00
1	168106A	SENSORY PLAY PANEL XYLOFUN	\$2,780.00	\$2,780.00
49	100626A	30" GALVANIZED STAKE FOR BORDERS	\$8.00	\$392.00
42	119214A	TUFFTIMBER 4' BORDER	\$34.00	\$1,428.00
2	130799A	TUFFTIMBER ACCESS RAMP	\$565.00	\$1,130.00
ZEAGER				
100	CU YDS	WOOD CARPET FALL PROTECTION 12" DEEP	\$18.50	\$1,850.00
THE PRICE INCLUDES SHIPPING COST, THE PRICE DOESN'T INCLUDE UNLOADING, STORAGE, OR INSTALLATION			SUB:	\$42,410.00
THE ABOVE EQUIPMENT CAN BE PURCHASED ON PA STATE CONTRACT OR COSTARS			Freight:	\$0.00
Quote valid for 90 days To confirm order please sign below on the line and fax to 412-341-6711			SUB:	\$42,410.00
Signature _____			Sales Tax:	\$0.00
			Total:	\$42,410.00
GENERAL RECREATION, INC.				

AREA WITHIN
TUFTIMBERS
1890 SQ.FT.

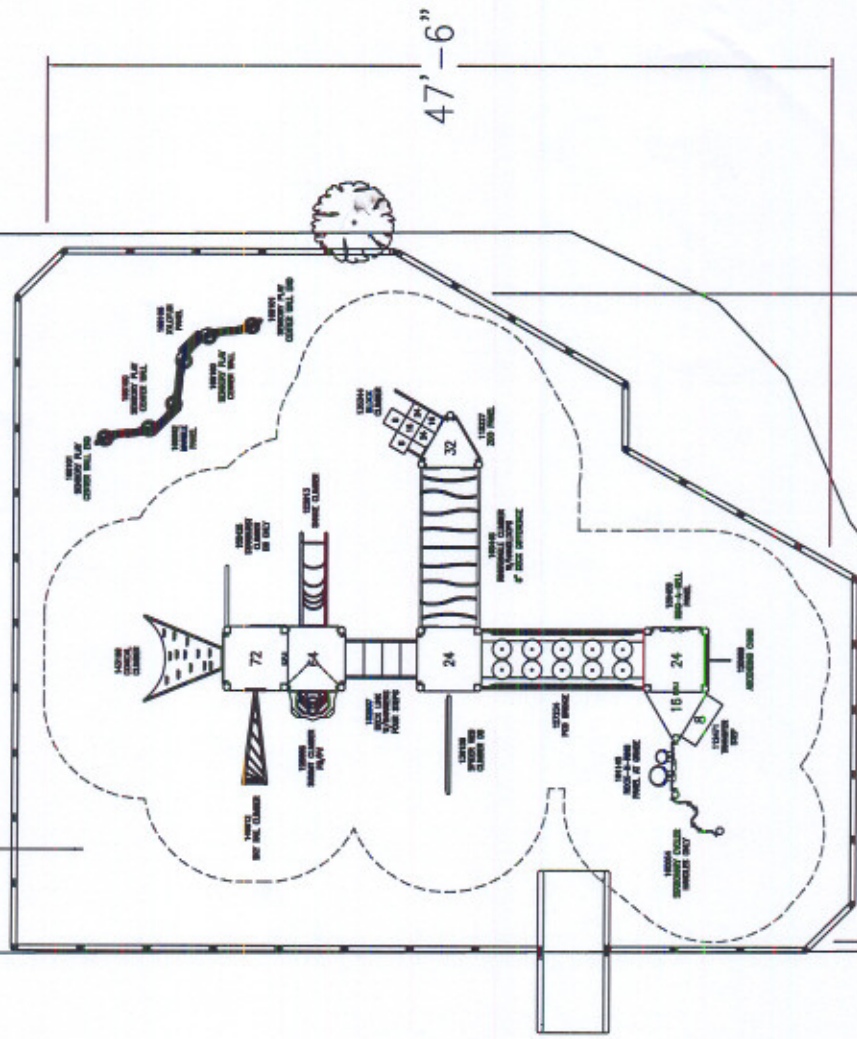

47'-6"

39'-9"

landscape
structures



The play components identified on this plan are IPEMA certified. (Unless otherwise noted) The use and layout of these components conform to the requirements of ASTM F1487.

THIS PLAY AREA & EQUIPMENT IS DESIGNED FOR AGES 5-12 YEARS UNLESS OTHERWISE NOTED ON PLAN.

IT IS THE MANUFACTURER'S OPINION THAT THIS PLAY AREA DOES NOT CONFORM TO THE ADA ACCESSIBILITY GUIDELINES (AGAG).

THIS CONCEPTUAL PLAN WAS BASED ON INFORMATION AVAILABLE TO US PRIOR TO CONSTRUCTION. IT INCLUDES THE INFORMATION INCLUDING SITE CONDITIONS, TOPOGRAPHY, EXISTING UTILITIES, SOIL CONDITIONS, AND DRAINAGE SOLUTIONS SHOULD BE OBTAINED, EXPLAINED, & UTILIZED IN THE FINAL DESIGN. PLEASE VERIFY ALL DIMENSIONS OF PLAY AREA, RATE, ORIENTATION, AND LOCATION OF ALL EXISTING UTILITIES, EQUIPMENT, AND SITE FURNISHINGS PRIOR TO CONSTRUCTION. SLIDES SHOULD NOT FACE THE HOT AFTERNOON SUN.

CHOOSE A PROTECTIVE SURROUNDING MATERIAL THAT HAS A CRITICAL HEIGHT VALUE OF AT LEAST THE HEIGHT OF THE HIGHEST ACCESSIBLE FINISHERY HEIGHT OF THE ADJACENT EQUIPMENT. (NOT CONSUMER PRODUCT SAFETY COMMISSION (CPSC) GUIDELINES, SECTION 12. SURFACING).

ACCESSIBLE/PROTECTIVE
LOOSE FILL MATERIAL
(ENHANCED WOOD FIBER SUGGESTED)

DESIGNED BY:

GLG

COMPARED 7/1/10
LANDSCAPE STRUCTURES, INC.
801 2ND STREET SUITE 100 - P.O. BOX 100
MILWAUKEE, WISCONSIN 53201
TEL 1-800-360-0000 FAX 1-760-400-0000

6/26/10	44815-1-1	GLG
Date	Previous Drawing #	Initials

WARREN AREA
ELEMENTARY CENTER
WARREN, PA

GENERAL
RECREATION, INC.
CURTIS BISCHOF

SYSTEM TYPE:
PLAYBOOSTER

DRAWING #:
44815-1-2



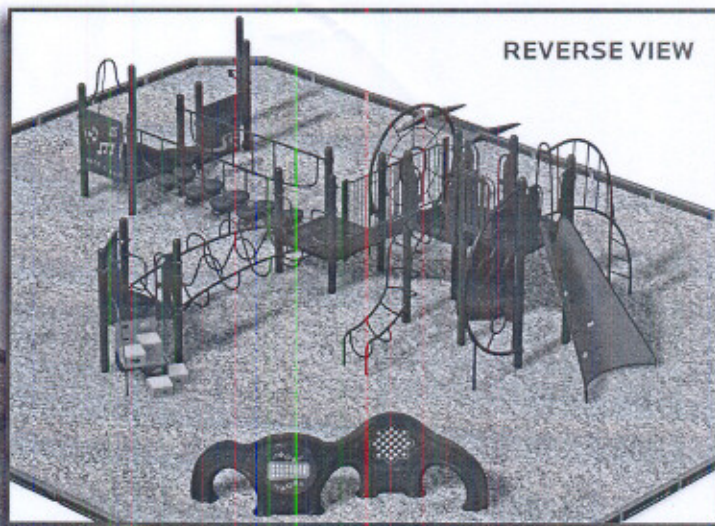

WARREN AREA ELEMENTARY CENTER

WARREN, PA

17144615-1-2

7/1/2010 2

 GENERAL RECREATION, INC.
SAFETY • QUALITY • SERVICE • INNOVATION • FUN



**landscape
structures**