



Educational & Contract Furniture

5335 Progress Blvd.

Bethel Park, PA 15102

Phone: 412-831-7601 Fax: 412-831-7662 Toll Free: 1-800-889-1160

Website: www.pemcofurniture.com

PROPOSAL

Number BJFLO1180

Date Jun 3, 2014

Sold To

Warren County School District
Kristie Bednez
589 Hospital Drive
Suite A
Warren, PA 16365
Phone 814-723-6900
Fax

Ship To

Warren County School District
Kristie Bednez
589 Hospital Drive
Suite A
Warren, PA 16365
Phone 814-723-6900
Fax

Your Sales Rep

Bill Lindstrom

Office: Ext.

Cell: 814-553-1640

Email: bill@pemcofurniture.com

Terms

PO Number

Qty	Mfg	Model #	Description	Unit Price	Ext. Price
617	American Seating	674	Dimension Auditorium Seat, Plastic Seat and Back, Straight Beam design with plastic arms. 66 Aisle Lights (120V, 60 Cycle, 6 Watt), 66 Laminate End Panels, 617 Aluminum Number/Letter Plates. Finishes TBD.	\$198.00	\$122,166.00
1	PEMCO		Installation Charges - Assumption of Aisle Lights and Laminate End Panels - Removal of existing seating by others. Strictly for budget purposes only. Final drawings to include number of aisles, field measurements, etc. will need completed to arrive at an accurate quote.	\$29,000.00	\$29,000.00

Make PO out to:
American Seating
401 American Seating Ctr NW
Grand Rapids, MI 49504
PA State Contract #4400009338
Fax PO to 412-831-7662

SubTotal	\$151,166.00
Tax	\$0.00
Shipping	\$0.00

Signature _____

Date: _____

Total	\$151,166.00
-------	--------------

Proposal Expires on: 7/3/2014



Educational & Contract Furniture

5335 Progress Blvd.

Bethel Park, PA 15102

Phone: 412-831-7601 Fax: 412-831-7662 Toll Free: 1-800-889-1160

Website: www.pemcofurniture.com

PROPOSAL

Number BJFLQ1181

Date Jun 3, 2014

Sold To

Warren County School District
Kristie Bednez
589 Hospital Drive
Suite A
Warren, PA 16365
Phone 814-723-6900
Fax

Ship To

Warren County School District
Kristie Bednez
589 Hospital Drive
Suite A
Warren, PA 16365
Phone 814-723-6900
Fax

Your Sales Rep

Bill Lindstrom

Office: Ext.

Cell: 814-553-1640

Email: bill@pemcofurniture.com

Terms

PO Number

Qty	Mfg	Model #	Description	Unit Price	Ext. Price
617	American Seating	931A01	Core Auditorium Seat, Upholstered seat and back rest with plastic arms. Self rising, gravity lift seat design requires no maintenance. 66 Aisle Lights with Oval Shape (12/24V), 617 Aluminum Number/Letter Plates. Grade 2 Fabric, plastic colors TBD.	\$145.00	\$89,465.00
1	PEMCO		Installation Charges - Assumption of Aisle Lights and Laminate End Panels - Removal of existing seating by others. Strictly for budget purposes only. Final drawings to include number of aisles, field measurements, etc. will need completed to arrive at an accurate quote.	\$21,500.00	\$21,500.00

Make PO out to:
American Seating
401 American Seating Ctr NW
Grand Rapids, MI 49504
PA State Contract #4400009338
Fax PO to 412-831-7662

SubTotal	\$110,965.00
Tax	\$0.00
Shipping	\$0.00

Signature _____

Date: _____

Total	\$110,965.00
-------	--------------

Proposal Expires on:7/3/2014



Designed for Comfort. Engineered for the Environment.

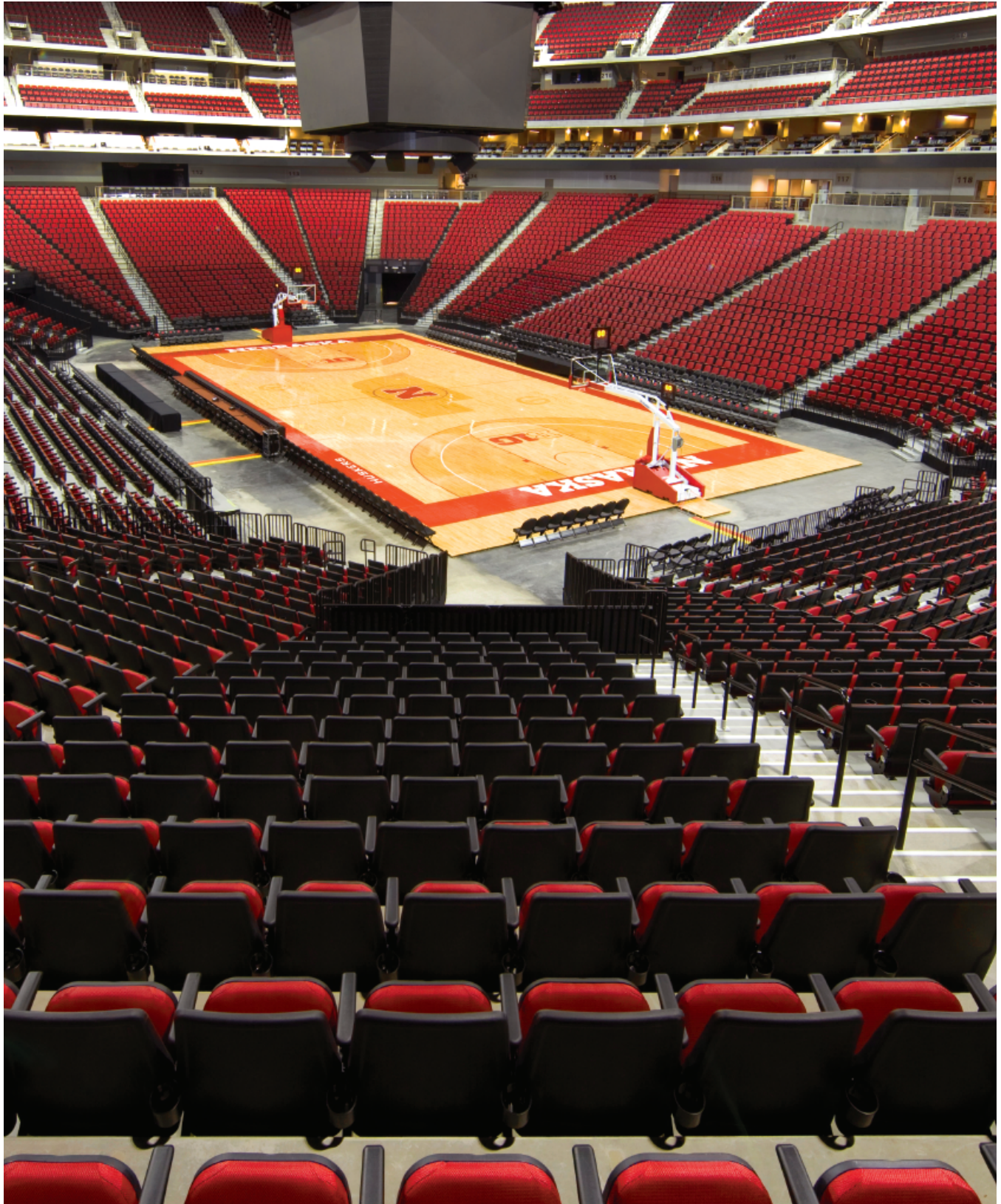



Thoughtful design and intelligent engineering were performed with core principles focused on sustainability and structural integrity. Metal brackets are engineered using high-tensile-strength steel and meet or exceed all industry test standards. The well-engineered copolymer seat, back and arm coverings are durable, attractive and easy to clean. The self-rising, gravity lift seat design is a maintenance free solution. **Core** holds up to the challenges of a busy classroom as well as the physical demands of indoor sporting events.



Seat Identification Tags



100% post-consumer recycled plastic back inner



Plastic Arm Caps



Rear Mount Cup Holder

Versatile Features and Options to Complement any Venue

Back angles can be fixed at various degrees for both 34" and 36" back heights

A.D.A. compliant

Three quarter fold seat offers easy access and hands free user movement

The tablet arm surface folds smoothly out of the way when not in use

Gravity lift seat enables the seat to return to the up position when not in use

Robotic fully seam welded steel standard ensures consistent structural properties

Three module component sets create six chair widths from 19" to 24"

The curved back inner provides base comfort and ergonomic support

No adhesives (VOCs) used in the upholstery process

Engineered copolymer seat, back and arm rests are durable and easy to clean

Seat ID recessed directly into the seat pan

Structural inner seat back made with patented ReTek® recycling process



60% of **Core's** weight is made of post-consumer recycled materials

Material Samples Available



Orientated strand board (OSB) seat structure under a 3" molded foam cushion provides enduring comfort, strength and sustainability



Plastic Backs



Plywood Veneer Backs



Wood Arm Cap and Wood End Panel



Laminate End Panel. Row Identification and Aisle Light, available with low voltage and LED bulbs

Our Mission

Since 1886, American Seating has set the standard for product design, durability and comfort. Today, we remain committed to exceeding the expectations of our customers. Our achievements serve as the platform for new and innovative products that continue to be the benchmark of our industry.



401 American Seating Center, Grand Rapids, MI 49504-4499
Phone 616-732-6600 800-748-0268 FAX 616-732-6401
americanseating.com

American Seating is registered trademark of American Seating Company.
Core is a trademark of American Seating Company.
Form No. A-CORE-14 ©2014 American Seating Company Litho USA



American Seating is committed to lessening our impact on the planet through responsible stewardship of our environment.

Dimension®

The Space-Saving, Versatile Solution
for Lecture Halls, Stadiums,
Arenas and Courtrooms



The Versatile System That Maximizes Seating Capacity and Comfort.



Dimension 674

Double-wall plastic seat and back



Dimension 675

Doubled-wall plastic seat and back shells with padded fabric inserts



Dimension 677

Fully upholstered seat and back

Dimension® is an ergonomic chair which allows for more clearance space behind unoccupied seats, making it ideal for environments that desire greater seating capacity within limited space.

The **674** and **675** models offer a three-quarter fold seat and an articulating back which moves to an upright when not in use. The slim envelope design allows for more space than traditional fixed back seating solutions. Model **677** varies slightly from the **674** and **675** models with a natural recline that can be adjusted manually to an upright position.

Dimension Spacing

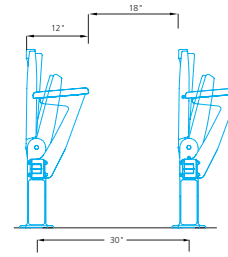

Traditional Spacing

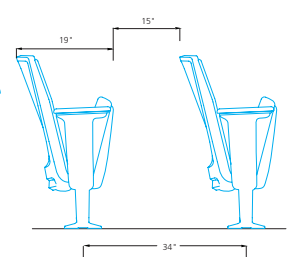

- a. Double-wall molded plastic seat and back with padded fabric inserts
- Seat and back also available in all plastic or fully upholstered options

- b. Row letter plate

- c. Donor plate

- d. Three-quarter fold seat hinge, and automatic or manual forward articulating back

- e. Seat number plate

- f. Wood and plastic armrests or armless models are available



Chair modules are interchangeable throughout the **Dimension** system, regardless of mounting style. Modules requiring replacement can be easily removed. One size module allows for reduced inventories.



Fixed beam mounting for general seating or suite chairs



Dimension's articulating back and $\frac{3}{4}$ fold up seat offers increased accessibility behind unoccupied seats

Dimension® Offers Options for Added Flexibility.

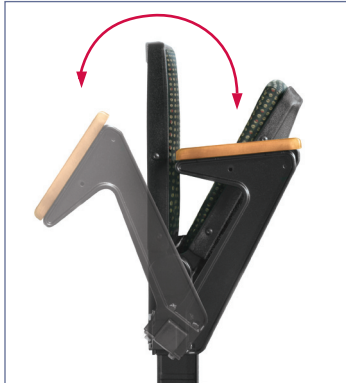

A.D.A. Compliance

Dimension is designed to meet all of the accessibility compliance standards of the Americans With Disabilities Act (A.D.A.).



Armrests

Dimension armrests are available in a plastic or wood.



Seat/Row Identification

Seat and row identification, and donor plates are available.



Folding Tablet Arms

Standard ($12\frac{3}{16}$ " x $13\frac{1}{8}$ ") and oversized ($15\frac{3}{8}$ " x $13\frac{3}{16}$ ") tablet arms available (standard shown). Tablet arms meet Life Safety Code (NFPA 101) and International Building Code.



Power and Data Raceways

U.L. listed raceway offers convenient access to power and data. The raceway includes one data port location and one simplex electrical outlet per chair, providing power for up to twenty-six chairs per power feed.



Aisle Lights

Light on end of beam directs soft glow downward.

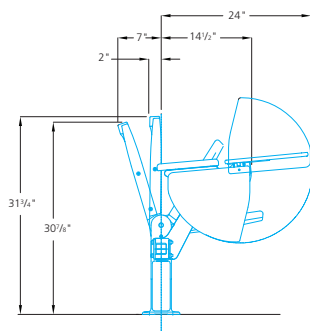

674
with standard tablet arm

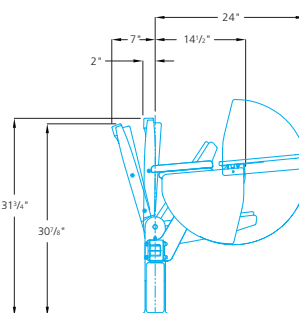

675
with standard tablet arm

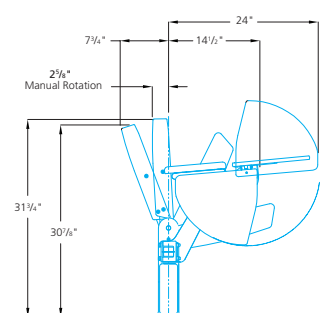

677
with standard tablet arm

Since 1886, American Seating has set the standard for product design, durability and comfort. Today, we remain committed to exceeding the expectations of our customers. Our achievements serve as the platform for new and innovative products that continue to be the benchmark of our industry.



401 American Seating Center
Grand Rapids, MI 49504-4499
Phone 616-732-6600 800-748-0268
FAX 616-732-6401
americanseating.com